

CRESCENT BEACH

Office E-mail: frontdeskcbcmarco@gmail.com

x Mary Jo Mueller the owner(s) of Unit X 600

To install (1) Roll down Shutters + (2) Bug Screens

Color of Rolldown will be Ivory

Color of Bug Screen will be black and housed with roll downs
to Indemnify and Hold Harmless Crescent Beach Condominium Association, Inc. for any loss, costs or damage to

Contractor shall be responsible for obtaining all necessary permits and approvals.
*Owner(s) Signature: X Mary Jo Mueller Date X 5-4-22
Signature: _____ Date X _____

~~Renovations may 1st and finish no later than September 30th, or forfeit their deposit as a refund for each day after the September 30th. Work hours: MON-FRI ONLY: 8:00 A.M. TO 4:00 P.M.~~

X _____ (Owner Initial) X _____ (Owner Initial)

ATTACH A COPY OF ALL SUBS WITH THEIR LICENSE & INSURANCE TO THIS FORM LISTING CRESCENT BEACH & OWNER AS CERTIFICATE HOLDER

Company: X 1st Choice Hurricane Protection, LLC Tele: () X 239-325-3400

Estimated Date to Begin Work: X WD Estimated Date to Complete Work: X WD
(WD = Work Days, are pending permit, material and hoa approval)

CONTRACTORS SIGNATURE X [Signature] DATE X _____

ALL WATER SUPPLY LINES UNDER KITCHEN SINKS & TOILETS MUST BE HARD PIPE NO. STAINLESS STEEL FLEXIBLE

ATTACH A SHEET EXPLAINING DETAILS WITH BLUEPRINT, LICENSE & INSURANCE LISTING ASSOCIATION & HOMEOWNER AS CERTIFICATE HOLDER

"NO LOCK BOXES" ARE PERMITTED ON OWNERS DOOR"
Approve by Director: [Signature] Approved manager: Paul Corey Re-approve by Director: _____

100 N. Collier Blvd
 #600
 Marco Island FL 34145

Contractor - 239-325-3400

25241 Bernwood Dr. #6
 Bonita Springs FL 34135

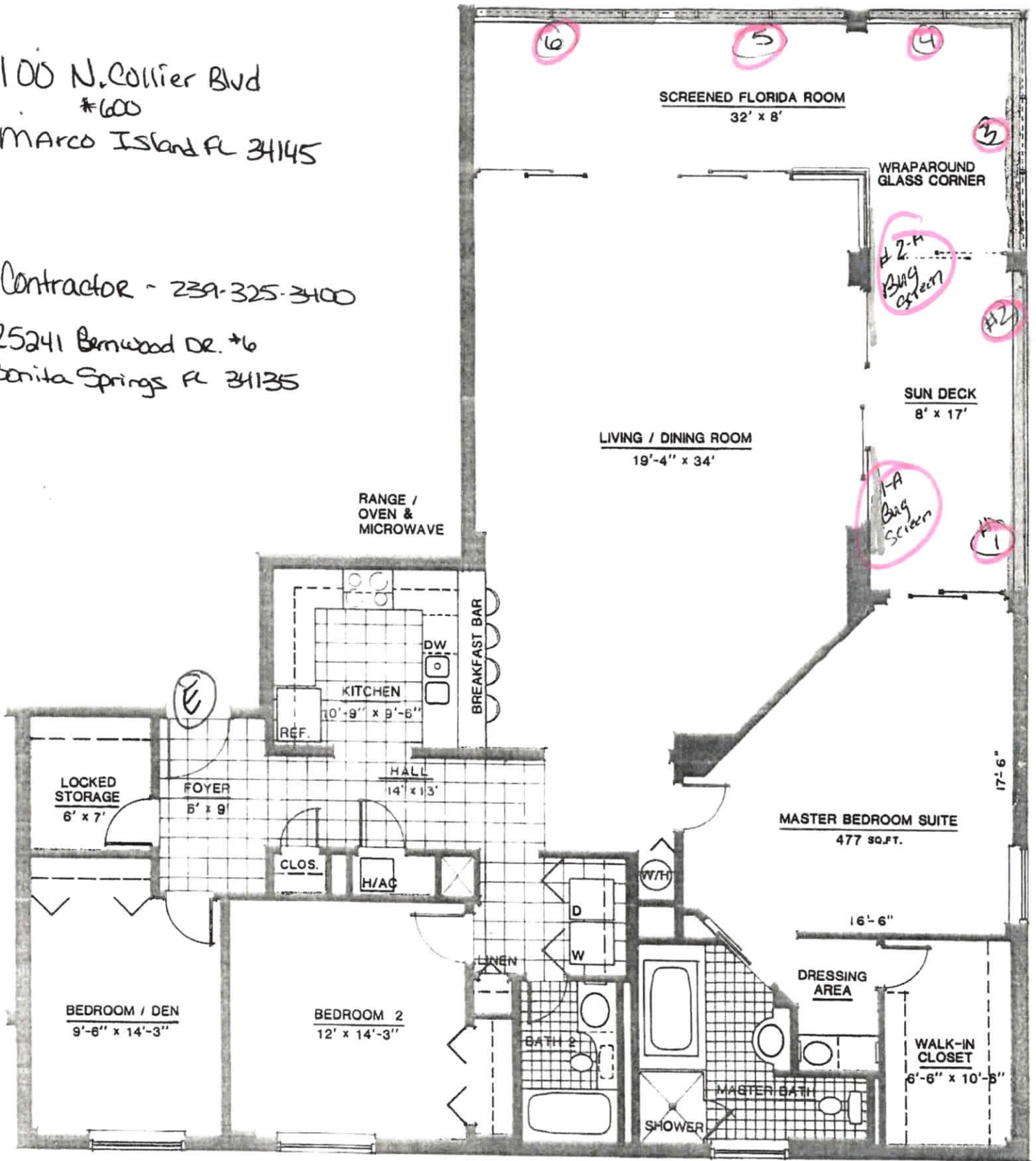

THREE BEDROOM (or DEN) - TWO & ONE THIRD BATHS
'B' FLOOR PLAN - CORNER UNIT

TOTAL LIVING AREA : 2269 SQ. FT.
 A/C AREA : 1877 SQ. FT.
 DIMENSIONS & CALCULATIONS ARE APPROXIMATE





Ron DeSantis, Governor

Halsey Beshears, Secretary



DEPARTMENT OF BUSINESS AND PROFESSIONAL REGULATION

CONSTRUCTION INDUSTRY LICENSING BOARD

THE GENERAL CONTRACTOR HEREIN IS CERTIFIED UNDER THE PROVISIONS OF CHAPTER 489, FLORIDA STATUTES

LUSTIK, LANCE WILLIAM

1ST CHOICE HURRICANE PROTECTION LLC
25241 BERNWOOD DR SUITE 6
BONITA SPRINGS FL 34135

LICENSE NUMBER: CGC1522106

EXPIRATION DATE: AUGUST 31, 2022

Always verify licenses online at MyFloridalicense.com

Do not alter this document in any form.

This is your license. It is unlawful for anyone other than the licensee to use this document.





CERTIFICATE OF LIABILITY INSURANCE

DATE (MM/DD/YYYY)

1/6/2022

THIS CERTIFICATE IS ISSUED AS A MATTER OF INFORMATION ONLY AND CONFERS NO RIGHTS UPON THE CERTIFICATE HOLDER. THIS CERTIFICATE DOES NOT AFFIRMATIVELY OR NEGATIVELY AMEND, EXTEND OR ALTER THE COVERAGE AFFORDED BY THE POLICIES BELOW. THIS CERTIFICATE OF INSURANCE DOES NOT CONSTITUTE A CONTRACT BETWEEN THE ISSUING INSURER(S), AUTHORIZED REPRESENTATIVE OR PRODUCER, AND THE CERTIFICATE HOLDER.

IMPORTANT: If the certificate holder is an ADDITIONAL INSURED, the policy(ies) must have ADDITIONAL INSURED provisions or be endorsed. If SUBROGATION IS WAIVED, subject to the terms and conditions of the policy, certain policies may require an endorsement. A statement on this certificate does not confer rights to the certificate holder in lieu of such endorsement(s).

PRODUCER Arthur J. Gallagher Risk Management Services, Inc. 1395 Panther Lane Suite 100 Naples FL 34109		CONTACT NAME: Teresa Brown PHONE (A/C, No, Ext): 239-262-7171 FAX (A/C, No): 239-262-5360 E-MAIL ADDRESS: Teresa_Brown1@ajg.com	
INSURED 1st Choice Hurricane Protection LLC. & 1st Choice Windows & Shutters, LLC. 25241 Bernwood Dr, #6 Bonita Springs FL 34145		INSURER(S) AFFORDING COVERAGE NAIC # INSURER A: Auto-Owners Insurance Company 18988 INSURER B: Southern-Owners Insurance Company 10190 INSURER C: INSURER D: INSURER E: INSURER F:	

COVERAGES

CERTIFICATE NUMBER: 110307630

REVISION NUMBER:

THIS IS TO CERTIFY THAT THE POLICIES OF INSURANCE LISTED BELOW HAVE BEEN ISSUED TO THE INSURED NAMED ABOVE FOR THE POLICY PERIOD INDICATED. NOTWITHSTANDING ANY REQUIREMENT, TERM OR CONDITION OF ANY CONTRACT OR OTHER DOCUMENT WITH RESPECT TO WHICH THIS CERTIFICATE MAY BE ISSUED OR MAY PERTAIN, THE INSURANCE AFFORDED BY THE POLICIES DESCRIBED HEREIN IS SUBJECT TO ALL THE TERMS, EXCLUSIONS AND CONDITIONS OF SUCH POLICIES. LIMITS SHOWN MAY HAVE BEEN REDUCED BY PAID CLAIMS.

INSR. LTR	TYPE OF INSURANCE	ADDITIONAL INSURER	POLICY NUMBER	POLICY EFF (MM/DD/YYYY)	POLICY EXP (MM/DD/YYYY)	LIMITS
B X	COMMERCIAL GENERAL LIABILITY <input type="checkbox"/> CLAIMS-MADE <input checked="" type="checkbox"/> OCCUR GEN'L AGGREGATE LIMIT APPLIES PER: <input type="checkbox"/> POLICY <input checked="" type="checkbox"/> PROJECT <input checked="" type="checkbox"/> LOC OTHER:		20136310	12/1/2021	12/1/2022	EACH OCCURRENCE \$ 1,000,000 DAMAGE TO RENTED PREMISES (Ea occurrence) \$ 300,000 MED EXP (Any one person) \$ 10,000 PERSONAL & ADV INJURY \$ 1,000,000 GENERAL AGGREGATE \$ 2,000,000 PRODUCTS - COMP/OP AGG \$ 2,000,000 \$
A	AUTOMOBILE LIABILITY <input type="checkbox"/> ANY AUTO <input type="checkbox"/> OWNED AUTOS ONLY <input checked="" type="checkbox"/> SCHEDULED AUTOS <input type="checkbox"/> HIRED AUTOS ONLY <input checked="" type="checkbox"/> NON-OWNED AUTOS ONLY		4967381001	12/1/2021	12/1/2022	COMBINED SINGLE LIMIT (Ea accident) \$ BODILY INJURY (Per person) \$ 1,000,000 BODILY INJURY (Per accident) \$ 1,000,000 PROPERTY DAMAGE (Per accident) \$ 1,000,000 \$
B X	UMBRELLA LIAB <input checked="" type="checkbox"/> OCCUR <input type="checkbox"/> EXCESS LIAB <input type="checkbox"/> CLAIMS-MADE DED RETENTION \$		4967381002	12/1/2021	12/1/2022	EACH OCCURRENCE \$ 1,000,000 AGGREGATE \$ 1,000,000 \$
	WORKERS COMPENSATION AND EMPLOYERS' LIABILITY ANY PROPRIETOR/PARTNER/EXECUTIVE OFFICER/MEMBER EXCLUDED? (Mandatory in NH) If yes, describe under DESCRIPTION OF OPERATIONS below	Y/N	N/A			PER STATUTE OTHER E.L. EACH ACCIDENT \$ E.L. DISEASE - EA EMPLOYEE \$ E.L. DISEASE - POLICY LIMIT \$

DESCRIPTION OF OPERATIONS / LOCATIONS / VEHICLES (ACORD 101, Additional Remarks Schedule, may be attached if more space is required)

CERTIFICATE HOLDER**CANCELLATION**

Crescent Beach Condominium Association, Inc.
 100 N Collier Blvd
 Marco Island FL 34145
 USA

SHOULD ANY OF THE ABOVE DESCRIBED POLICIES BE CANCELLED BEFORE THE EXPIRATION DATE THEREOF, NOTICE WILL BE DELIVERED IN ACCORDANCE WITH THE POLICY PROVISIONS.

AUTHORIZED REPRESENTATIVE

© 1988-2015 ACORD CORPORATION. All rights reserved.

CERTIFICATE OF LIABILITY INSURANCE

Date
12/7/2021

Producer: Plymouth Insurance Agency
2739 U.S. Highway 19 N.
Holiday, FL 34691
(727) 938-5562

This Certificate is issued as a matter of information only and confers no rights upon the Certificate Holder. This Certificate does not amend, extend or alter the coverage afforded by the policies below.

Insured: South East Personnel Leasing, Inc. & Subsidiaries
2739 U.S. Highway 19 N.
Holiday, FL 34691

Insurers Affording Coverage		NAIC #
Insurer A:	Lion Insurance Company	11075
Insurer B:		
Insurer C:		
Insurer D:		
Insurer E:		

Coverages

The policies of insurance listed below have been issued to the insured named above for the policy period indicated. Notwithstanding any requirement, term or condition of any contract or other document with respect to which this certificate may be issued or may pertain, the insurance afforded by the policies described herein is subject to all the terms, exclusions, and conditions of such policies. Aggregate limits shown may have been reduced by paid claims.

INSR LTR	ADDL INSRD	Type of Insurance	Policy Number	Policy Effective Date (MM/DD/YY)	Policy Expiration Date (MM/DD/YY)	Limits																
		GENERAL LIABILITY <input type="checkbox"/> Commercial General Liability <input type="checkbox"/> Claims Made <input type="checkbox"/> Occur <hr/> General aggregate limit applies per: <input type="checkbox"/> Policy <input type="checkbox"/> Project <input type="checkbox"/> LOC				Each Occurrence Damage to rented premises (EA occurrence) Med Exp Personal Adv Injury General Aggregate Products - Comp/Op Agg																
		AUTOMOBILE LIABILITY <input type="checkbox"/> Any Auto <input type="checkbox"/> All Owned Autos <input type="checkbox"/> Scheduled Autos <input type="checkbox"/> Hired Autos <input type="checkbox"/> Non-Owned Autos				Combined Single Limit (EA Accident) Bodily Injury (Per Person) Bodily Injury (Per Accident) Property Damage (Per Accident)																
		EXCESS/UMBRELLA LIABILITY <input type="checkbox"/> Occur <input type="checkbox"/> Claims Made Deductible				Each Occurrence Aggregate																
A		Workers Compensation and Employers' Liability Any proprietor/partner/executive officer/member excluded? NO If Yes, describe under special provisions below.	WC 71949	01/01/2022	01/01/2023	<table border="1" style="width: 100%; border-collapse: collapse;"> <tr> <td style="text-align: center;">X</td> <td style="text-align: center;">WC Statutory Limits</td> <td style="text-align: center;">OTH-ER</td> <td></td> </tr> <tr> <td></td> <td>E.L. Each Accident</td> <td></td> <td style="text-align: right;">\$1,000,000</td> </tr> <tr> <td></td> <td>E.L. Disease - Ea Employee</td> <td></td> <td style="text-align: right;">\$1,000,000</td> </tr> <tr> <td></td> <td>E.L. Disease - Policy Limits</td> <td></td> <td style="text-align: right;">\$1,000,000</td> </tr> </table>	X	WC Statutory Limits	OTH-ER			E.L. Each Accident		\$1,000,000		E.L. Disease - Ea Employee		\$1,000,000		E.L. Disease - Policy Limits		\$1,000,000
X	WC Statutory Limits	OTH-ER																				
	E.L. Each Accident		\$1,000,000																			
	E.L. Disease - Ea Employee		\$1,000,000																			
	E.L. Disease - Policy Limits		\$1,000,000																			

Other

Lion Insurance Company is A.M. Best Company rated A (Excellent). AMB # 12616

Descriptions of Operations/Locations/Vehicles/Exclusions added by Endorsement/Special Provisions:

Client ID: 90-67-576

Coverage only applies to active employee(s) of South East Personnel Leasing, Inc. & Subsidiaries that are leased to the following "Client Company":

1st Choice Hurricane Protection LLC

Coverage only applies to injuries incurred by South East Personnel Leasing, Inc. & Subsidiaries active employee(s), while working in: FL

Coverage does not apply to statutory employee(s) or independent contractor(s) of the Client Company or any other entity.

A list of the active employee(s) leased to the Client Company can be obtained by faxing a request to (727) 937-2138 or email certificates@lioninsurancecompany.com

Project Name:

ISSUE 01-04-21 (SS)

Begin Date: 4/22/2019

CERTIFICATE HOLDER

CRESCENT BEACH
CONDOMINIUM ASSOCIATION INC
100 N COLLIER BLVD
MARCO ISLAND, FL 34145

CANCELLATION

Should any of the above described policies be cancelled before the expiration date thereof, the issuing insurer will endeavor to mail 30 days written notice to the certificate holder named to the left, but failure to do so shall impose no obligation or liability of any kind upon the insurer, its agents or representatives.

Eastern Metal Supply

55mm Bertha™ End Retention Roll Shutters



55mm Bertha™ End Retention Roll Shutters

Product Features:

- End Retention
- Vented slats let the light in
- Block the sun, wind, and rain
- Protect your patio, windows and doors
- Offers comfort and security
- Double wall slat for wide spans and strength
- Powder coated paint finish

Specifications:

- Hurricane tested and approved
- Approvals: FBC-HVHZ, Non-HVHZ, IBC/IRC, TDI - Pending
- Up to 286 1/2" wide

Options Include:

- Colors: White, Ivory, Beige, Bronze
- See out with View Ports • Motorization
- Operate with your smartphone • Storm bars
- Spring loaded system/fingertip control



Eastern Metal Supply www.easternmetal.com • info@easternmetal.com

FL: 800-432-2204 • NC: 800-343-8154 • TX: 800-996-6061 • MO: 888-822-6061 v03/18

55MM BERTHA™ END RETENTION SYSTEM (ER)

Code Approvals: FBC Non-HVHZ, FBC HVHZ, TDI

55 MM VENTED Slat x 24'

40-COLOR-980

Sub Bundle
Size: 10

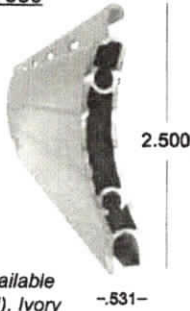

COLOR = available
in White (WH), Ivory
(IV), Bronze (MB)
and Beige (BG)

55mm ER NON VENTED

View Port Slat x 24'

40-COLOR-980VPMV

55mm ER View Port Insert (.118 x .845 x .96")

40-VP-990

Clear Polycarbonate



55mm ER Slat Lock Black

40-63-786 One Piece - NEW



55 MM End Retention Assembly Screws

Phillips Head Sheet Metal Screws

41108-100 (bags of 100)

All Points Product Code:

10N250TXFS/HV



55mm Small Leg Track x 24'

40-COLOR-476

Mates with 40-COLOR-486

Use with 41-HV-200 Felt

Also used with 40mm & Single Wall
systems

Sub Bundle Size: 4

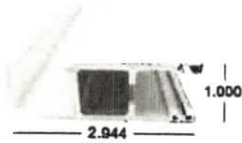

55mm Large Leg Track x 24'

40-COLOR-481

Mates with 40-COLOR-486

Use with 41-HV-200 Felt

Also used with 55mm & Single Wall
systems

Sub Bundle Size: 5



Cover Cap x 12'

40-COLOR-486

Mates 40-COLOR-476,

40-COLOR-481

Sub Bundle Size: 30



Roll Shutter Track Felt

(.200/.270)

41-HV-200

Black Felt Roll x 2000'

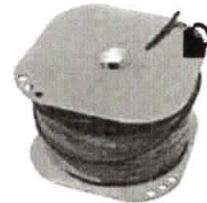

55mm Small Leg Closed Face

Track x 22' 6"

40-COLOR-478

Use with 41-HV-200 Felt

Also used with 40mm & Single Wall
systems

Sub Bundle Size: 4

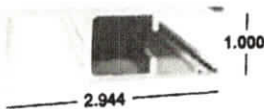

55mm Large Leg Closed

Face Track x 22' 6"

40-COLOR-483

Use with 41-HV-200 Felt

Also used with 40mm & Single
Wall Systems

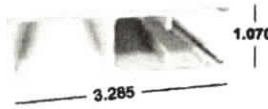

40mm Base Slat x 20'

40-COLOR-100

Mates with 40-COLOR-105

Sub Bundle

Size: 8



40mm Base Cover x 20'

40-COLOR-105

Mates with 40-COLOR-100

Sub Bundle

Size: 20



Base Slat Cylinder Lock

2003432-1

2003432-2

2003432-3

2003432-4



Base Slat Locking Rod

10-63-265

Mill Finish

3/16 x 1 x 20'



Base Slat Lock Guide

40-BK-800

Black

Plastic



55mm ER Hand Held

Sample

55ER-SAMPLE



HURRICANE 20



Eastern Metal Supply

www.easternmetal.com • info@easternmetal.com 08/13/20

FL: 800-432-2204 • NC/DE/GA: 800-343-8154 • TX/AR: 800-996-6061 • MO/OH: 888-822-6061

Mounting Options

- Flush Mount: Installed flush to the wall
- Trapped Mount: Installed in a restricted opening.
- Recessed Mount: Installed with side rails or hood concealed in a wall, ceiling or other architectural feature.

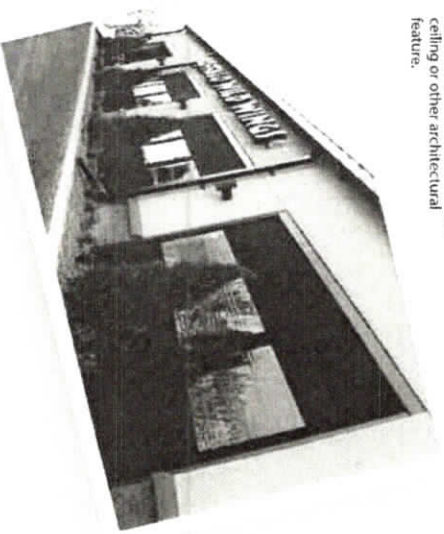

Suntex 80 Premium Solar

Fabric Choices:

17 x 20 Tuff Screen

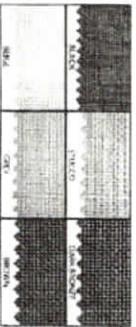
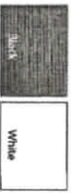

Suntex 90 Premium Solar



Frame Choices:



Warranties

Powder Coating Warranty: AAMA 2603 (Interpon D1010 - 10-year inland; 1-year coastal (within 1 mile of coastal shoreline)).

20-50NM Override Motors are supported by a 5-year replacement warranty. 20-50NMSmart Motors are supported by a 3-year replacement warranty.

Electronics are supported by a 2-year replacement warranty.

Enjoy the outdoors,
From indoors.

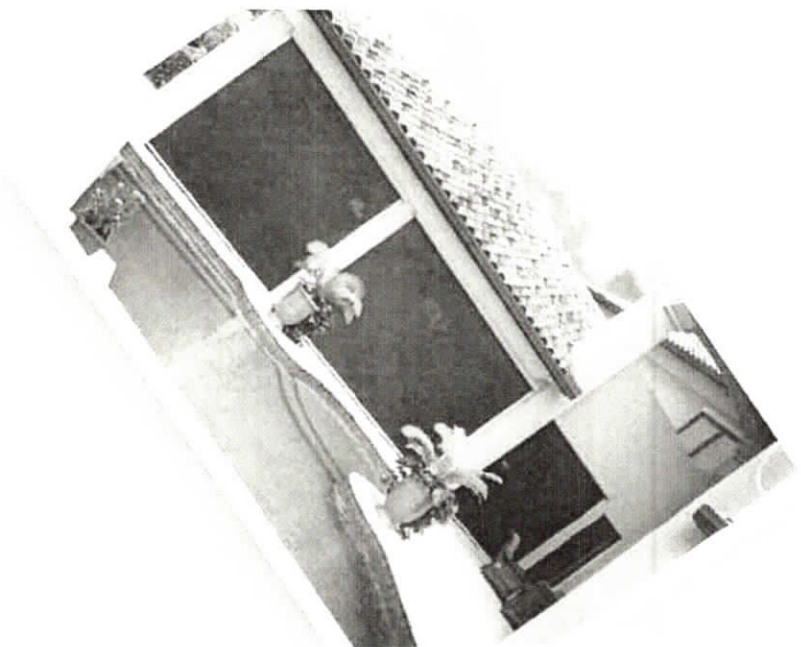

TCl
Motorized Screens™

by  **MicroShield®**
Protection Like No Other™

Enhance your Lifestyle!

When making an outdoor living space decision, you want to make sure you are receiving all the conveniences you desire in one product. A Motorized Screen will provide you with a modern and sophisticated home décor, while turning your patio into a center piece of the home. In a matter of seconds, you and the family will be able to enjoy a relaxing evening doing the finer things in life from the comfort of your own home.



Built Around Your Needs

No matter what your needs are, when you purchase a Motorized Screen, you have the piece of mind knowing we have the necessary components to satisfy them. Our system allows you, the homeowner, to completely customize each individual unit based on your LIFESTYLE.

From electronics to fabric density and color, to the frame color to remote controls, you will have the ability to adapt each screen to fit your home.

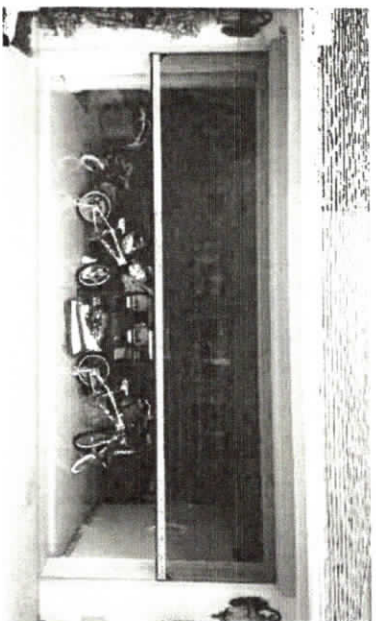

Expanded Outdoor Living Space

It's no secret all of us wish to utilize our outdoor living space more often and effectively. By choosing a motorized exterior screen, you are making a lifestyle decision. Our Motorized Screen will immediately increase the size of your family's living space while keeping the bugs out during the warmer months, allowing the breeze through during the cooler ones, as well as blocking harmful UV Rays. With the click of a button, you can now move your dinner outside with a breezy bug-free environment.

Questions to Answer:

- Which frame color do I want?
- Which bottom bar color do I want?
- What color and density screen would work best for my home?
- How would I like my unit mounted?
- Which electronic configuration would make operating my units easiest?

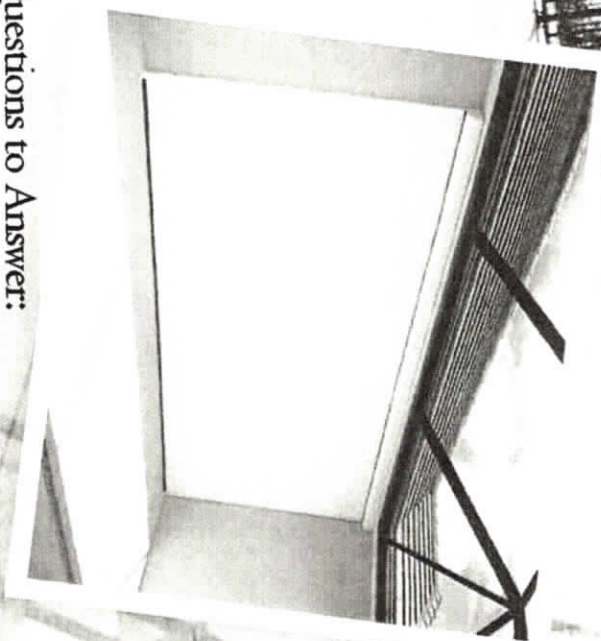

Electronics

The Motorized Screen electronics will put the beauty of your outdoor screen into motion. Designed by Swedish and American engineers, these industry leading components are the perfect marriage of power, precision and integration. Our state of the art electronics support low data rates, low power consumption, security and reliability. With a multitude of programming options, you have the convenience of total control and the quality assurance, technical support, and innovation that is the cornerstone of every product we offer. Our motors and electronics are innovation at its best. With multiple configurations available, the agility of our motors and electronics puts them in a class of their own.